

Ø 16 mm

C-TOP-16B

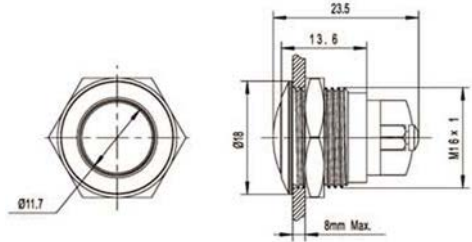

Diameter: Ø 16mm
 Switch Rating: 3A/250VAC
 Contact Configuration: 1NO
 Operation Type: Momentary
 The Front Shape: Flat
 The Crust Material:
 • Stainless steel
 • Copper plating
 IP Degree: IP67, IK10



C-TOP-16H



Diameter: Ø 16mm
 Switch Rating: 3A/250VAC
 Contact Configuration: 1NO
 Operation Type: Momentary
 The Front Shape: High
 The Crust Material:
 • Stainless steel
 • Copper plating
 IP Degree: IP67, IK10

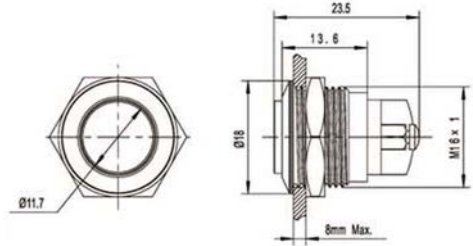

C-TOP-16FJ-L



Diameter: Ø 16mm
 Switch Rating: 3A/250VAC
 Contact Configuration: 1NO
 Operation Type: Maintained
 The Front Shape: Flat
 The Crust Material:
 • Stainless steel
 IP Degree: IP67, IK10

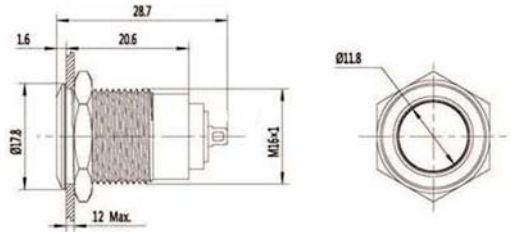

C-TOP-16BJ-L



Diameter: Ø 16mm
 Switch Rating: 3A/250VAC
 Contact Configuration: 1NO
 Operation Type: Maintained
 The Front Shape: Ball
 The Crust Material:
 • Stainless steel
 IP Degree: IP67, IK10

